

SERIES RVD ANGLE PATTERN RELIEF/BYPASS VALVE

Compact, economical design with PTFE spring guides

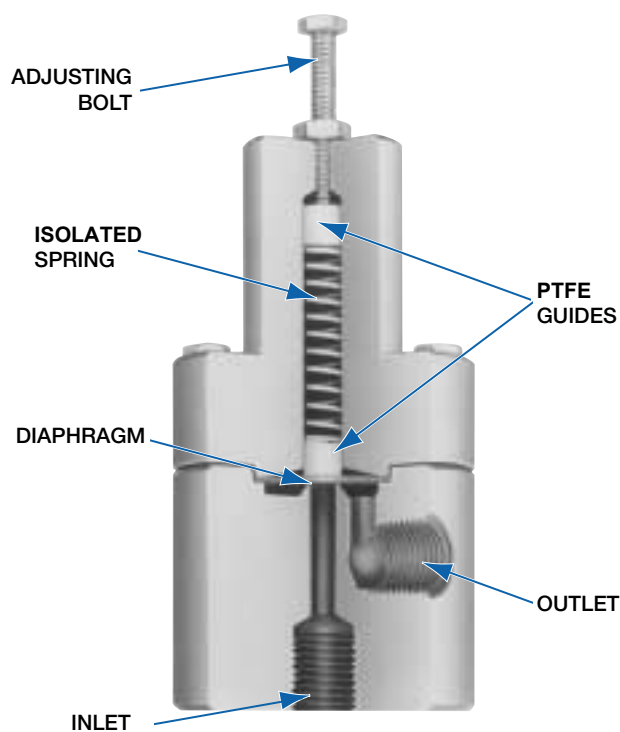

5-150 PSI set pressure range
210 PSI maximum inlet pressure

FEATURES

- Single diaphragm provides quick response, prevents crystallization.
- PTFE guides designed for smooth, chatter-free operation.
- Heavy-duty; machined from solid thermoplastics and built for corrosive applications.
- Designed for low maintenance and easy to adjust.
- Angle pattern in 1/4" and 1/2" pipe sizes.
- No wetted metal parts.

APPLICATIONS

Multi-purpose valve will function as:

Pressure Relief Valve – in a piping system or vessel to protect it from excess pressure

Back Pressure Regulator – at the end of a closed loop to maintain a pre-set upstream pressure

Bypass Relief – to protect the pump when an obstruction occurs downstream

Pump Backpressure Valve – to create an obstruction to the pump's output flow, to smooth out turbulence and improve pump longevity.

DESIGN

Series RVD angle pattern pressure relief valves features a single flat diaphragm which is an advantage where salt crystallization problems can cause valve sticking.

Relief setting is infinitely adjustable from 5 psi to 150 psi.

Maximum inlet pressure is 210 psi.

MATERIALS OF CONSTRUCTION

Available in PVC, Natural Polypropylene, PVDF and Teflon. Seals are available in EPDM or Viton®. The adjusting bolt, lock nut and fasteners are stainless steel. The control spring is plated steel. No metal parts are in contact with liquid.

FNPT connections standard.



SERIES RVD SPECIFICATIONS

FLOW PERFORMANCE

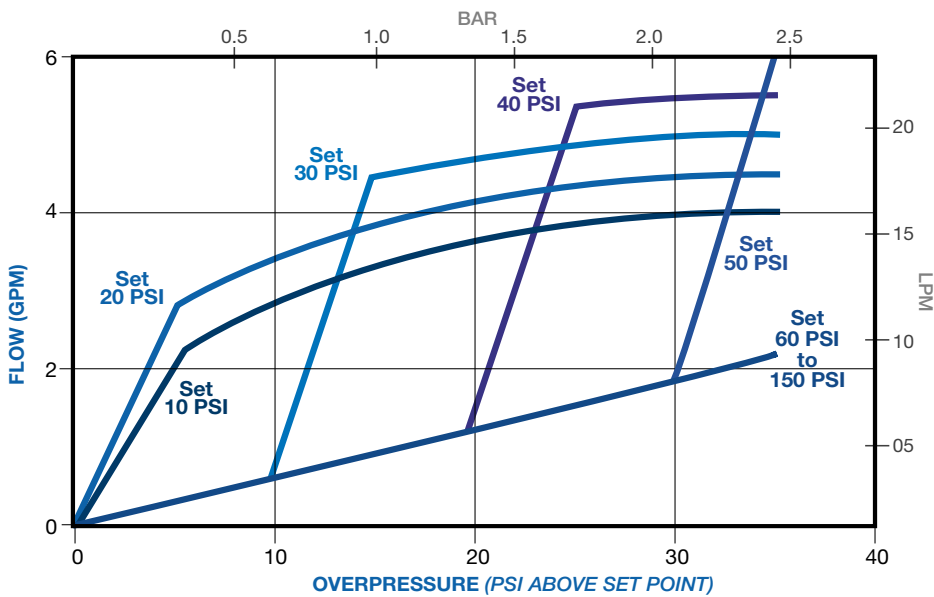

DIMENSIONS

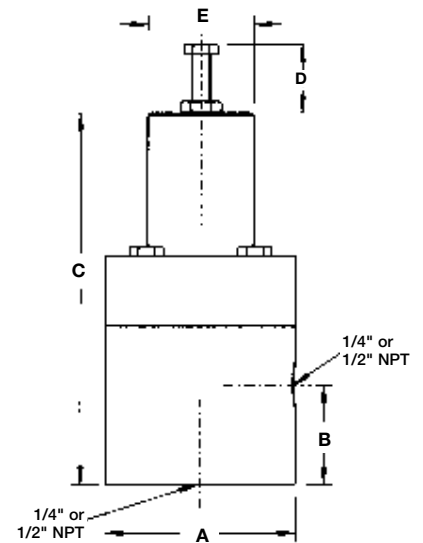

	NPT or BSP			
	1/4		1/2	
	in.	mm.	in.	mm.
A	2	50.8	2.375	60.3
B	1.125	28.5	1.500	38.1
C	4	100.6	4.687	119.0
D	1.125	28.5	1.125	28.5
E	1.125	28.5	1.125	28.5

ORDERING INFORMATION

PIPE SIZE	PVC Model No.	POLYPRO* Model No.	PVDF Model No.	TEFLON Model No.
1/4"	RVD025V-PV	RVD025V-PP	RVD025V-PF	RVD025V-TF
1/2"	RVD050V-PV	RVD050V-PP	RVD050V-PF	RVD050V-TF

*Natural unpigmented polypropylene

Part numbers shown with FKM seals (Viton). For EPDM seals, change V to EP, example: RVD025EP-PV.

For CPVC body material, change the material suffix to CP, example: RVD025V-CP.

Photos are representative. Appearance may vary based on size/materials.

